

SECTION A-A

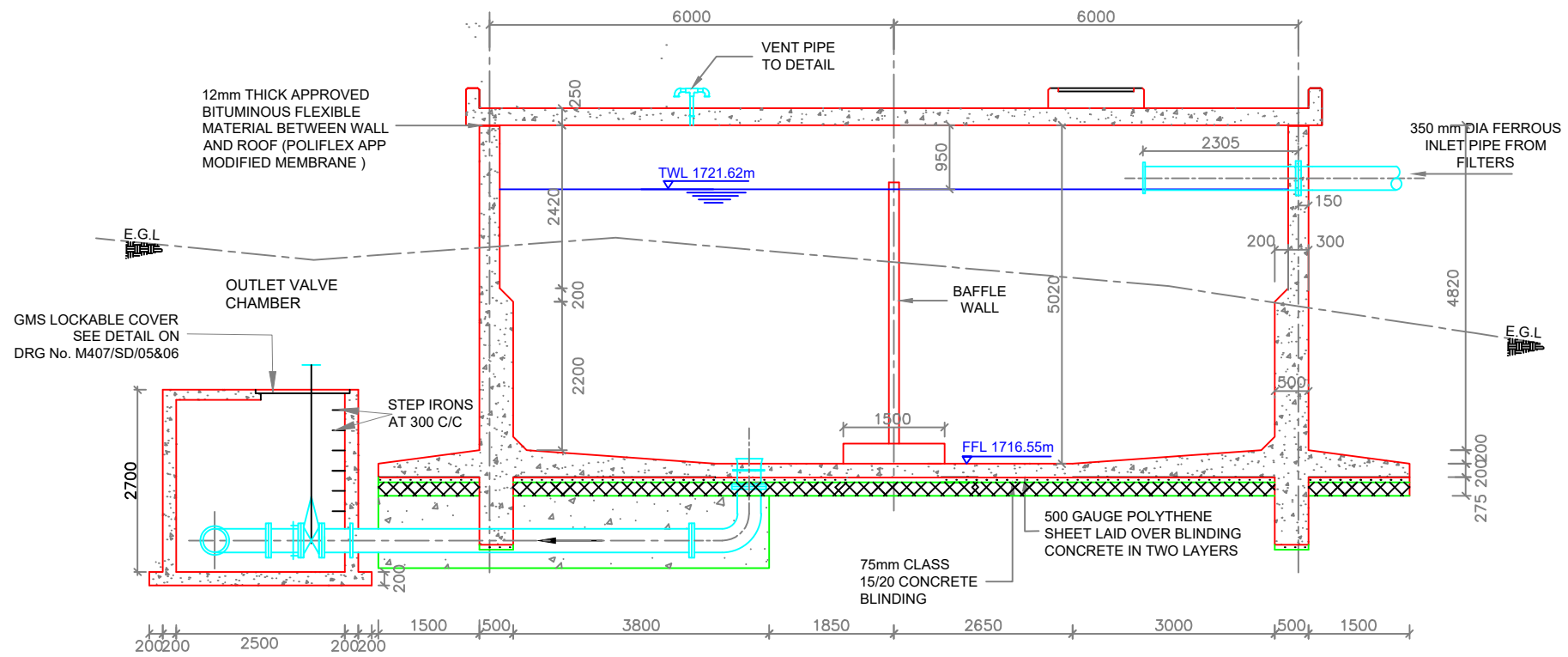

SECTION B-B

- NOTES:**
- ALL DIMENSIONS IN MILLIMETERS UNLESS OTHERWISE INDICATED
 - ALL EXPOSED CONCRETE EDGES TO HAVE A 25mm x 25mm CHAMFER
 - CONCRETE WORKS: ALL REINFORCED CONCRETE TO BE CLASS 25 /20 EXCEPT WHERE OTHERWISE SPECIFIED
 - ABBREVIATIONS:
 - R.C - REINFORCED CONCRETE
 - F.G.L - FINISHED GROUND LEVEL
 - E.G.L - EXISTING GROUND LEVEL
 - DN - NOMINAL DIAMETER
 - uPVC - UNPLASTICISED POLYVINYL CHLORIDE
 - G.I - GALVANIZED IRON
 - F.L - FINISHED LEVEL

CLIENT: **CHIEF EXECUTIVE OFFICER
TANA WATER WORKS
DEVELOPMENT AGENCY**
P.O BOX 1292 - 10100,
NYERI, KENYA

ENGINEER: **CHIEF MANAGER TECHNICAL
SERVICES
TANA WATER WORKS
DEVELOPMENT AGENCY**
P.O BOX 1292 - 10100,
NYERI, KENYA

PROJECT TITLE:

TETU WATER SUPPLY

DRAWING TITLE:

TETU WATER TREATMENT WORKS

**TREATED WATER TANK (500m³)
SECTIONS A - A & B - B**

Designed by: K.N.G	Drawn by: A.M.M
Checked by: J.M.M	Approved by: D.N.M
Scale: 1:100	Date: NOV 2023

DRG No. **TAWP/TWT/03**